

Technical characteristics

Power	Replaceable 3.6V type 1/2AA Lithium battery
Type of event recorded	NC or NO contact that the program is able to select. Ambient temperature at a fixed interval of 15'. An alarm is generated (it can be disabled) if the contact remains in an unstable condition for more than 3 seconds.
Resolution	From 0.050 to 1.599mm/sample
Storage capacity	93000 samples (equal to 18600mm of rain with a resolution of 0.2mm/sample) 2 years of temperature with a fixed interval of 15'
PC interface	Insulated RS232C serial port – 9600 baud
Display indications	Partial rain in millimetres or inches Total rain in millimetres or inches Environment temperature °C/°F
Operating temperature range	-20°C ... +60°C
Protection degree	IP67
Software supplied	DeltaLog6

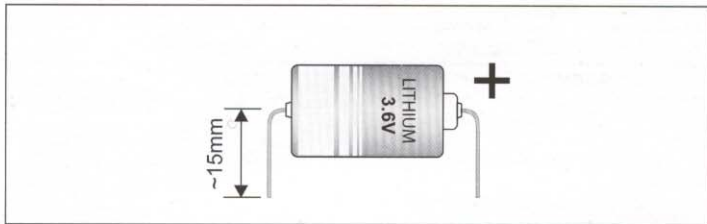

Fig. 5 3.6V Lithium battery

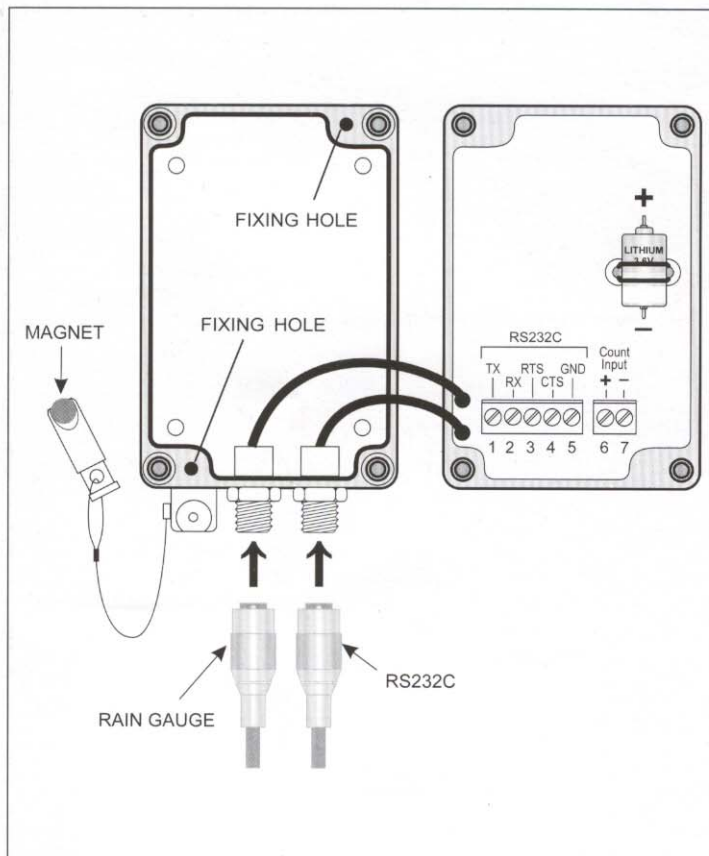

Fig. 6 Inside the instrument

Order codes

HD2013: Rain gauge with tipping bucket, area 400 cm², for temperatures from +4°C to +60°C; resolution on request, at the time of placing the order 0.1 - 0.2 or 0.5 mm. Output contact normally closed.

HD2013R: Rain gauge with tipping bucket, area 400 cm², for temperatures from -25 to +60°C; resolution on request, at the time of placing the order 0.1 - 0.2 or 0.5 mm. Output contact normally closed. Power voltage 12Vdc or 24Vdc ±10% / absorption 35W.

HD2013.18: Bird dissuader.

HD2013.5K: Accessory kit for installation of the 500 mm raised from ground rain gauge, formed by a support plate for the staff, support staff L=500 mm, fastening screws.

HD2013.75: Base with tip for the ground to support the raised from ground rain gauge (to add to the Accessory kit HD2013.5K).

HD2013.78: Level base for fastening the raised from ground rain gauge (to add to the Accessory kit HD2013.5K).

HD2013.77/40: Flange to fasten the datalogger to the support staff.

HD2013-D: Rain gauge datalogger with LCD display; reads and records up to 93000 impulses, given each time the bucket is emptied. Visualizes and updates the internal temperature every minute and saves it every 15 minutes. Insulated RS232C serial output, DeltaLog6 software supplied. 3.6V Lithium battery power. IP67 protection degree

CP2013.2P: One meter 3-pole cable to connect the rain gauge to the HD2013-D fixed to the support staff.

CP2013/RS232: 5-pole cable / RS232C to download data from datalogger to PC.



Device for data logger setting